

UNIT PLAN

1BHK 1T STUDY-TYPE 13

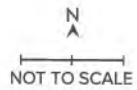

KEY PLAN



BLOCK - F



F-0245 - F-1745, F-0147 - F-1747 F-0146 - F-1746,
F-0148 - F-1748,



SUPER BUILT-UP AREA

62.74 Sq.m
675 Sq.ft

CARPET AREA

41.34 Sq.m
445 Sq.ft

BALCONY AREA

2.17 Sq.m
23 Sq.ft

The information depicted herein viz., master plans, floor plans, furniture layout, fittings, illustrations, specifications, designs, dimensions, rendered views, colours, amenities and facilities etc., are subject to change without notifications as may be required by the relevant authorities or the Developer's architect, and cannot form part of an offer or contract. Whilst every care is taken in providing this information, the Developer cannot be held liable for variations. All illustrations and pictures are artist's impressions only. The information is subject to variations, additions, deletions, substitutions and modifications as may be recommended by the company's architect and/or the relevant approving authorities. The Developer is wholly exempt from any liability on account of any claim in this regard. (1 square metre = 10.764 square feet). E & OE. All dimensions and calculations are done in metric system (M/Sq.m), and imperial system (Ft/Sq.ft) shown is for reference only. All dimensions indicated in the drawing are from unfinished surfaces, excluding plaster thickness and tile thickness.

UNIT PLAN

2BHK 2T-TYPE 12

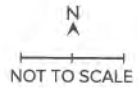

| SUPER BUILT-UP AREA | CARPET AREA | BALCONY AREA |
|---------------------|-------------|--------------|
| 107.18 Sq.m | 71.84 Sq.m | 4.48 Sq.m |
| 1154 Sq.ft | 773 Sq.ft | 48 Sq.ft |

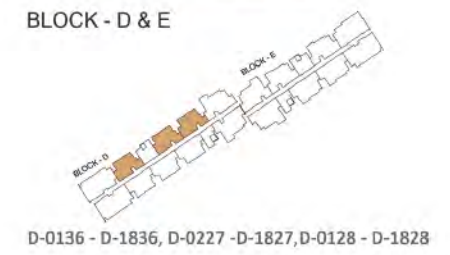

The information depicted herein viz., master plans, floor plans, furniture layout, fittings, illustrations, specifications, designs, dimensions, rendered views, colours, amenities and facilities etc., are subject to change without notifications as may be required by the relevant authorities or the Developer's architect, and cannot form part of an offer or contract. Whilst every care is taken in providing this information, the Developer cannot be held liable for variations. All illustrations and pictures are artist's impressions only. The information is subject to variations, additions, deletions, substitutions and modifications as may be recommended by the company's architect and/or the relevant approving authorities. The Developer is wholly exempt from any liability on account of any claim in this regard. (1 square metre = 10.764 square feet). E & OE. All dimensions and calculations are done in metric system (M/Sq.m), and imperial system (Ft/Sq.ft) shown is for reference only. All dimensions indicated in the drawing are from unfinished surfaces, excluding plaster thickness and tile thickness.

UNIT PLAN

3BHK 2T-TYPE 8

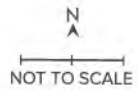

KEY PLAN



BLOCK - D & E

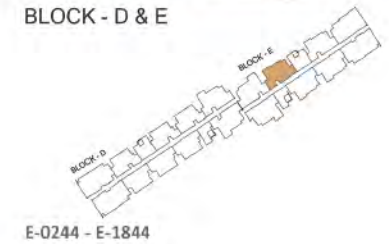

E-0244 - E-1844

SUPER BUILT-UP AREA

126.53 Sq.m
1362 Sq.ft

CARPET AREA

86.16 Sq.m
927 Sq.ft

BALCONY AREA

4.12 Sq.m
44 Sq.ft



The information depicted herein viz., master plans, floor plans, furniture layout, fittings, illustrations, specifications, designs, dimensions, rendered views, colours, amenities and facilities etc., are subject to change without notifications as may be required by the relevant authorities or the Developer's architect, and cannot form part of an offer or contract. Whilst every care is taken in providing this information, the Developer cannot be held liable for variations. All illustrations and pictures are artist's impressions only. The information is subject to variations, additions, deletions, substitutions and modifications as may be recommended by the company's architect and/or the relevant approving authorities. The Developer is wholly exempt from any liability on account of any claim in this regard. (1 square metre = 10.764 square feet). E & OE. All dimensions and calculations are done in metric system (M/Sq.m), and imperial system (Ft/Sq.ft) shown is for reference only. All dimensions indicated in the drawing are from unfinished surfaces, excluding plaster thickness and tile thickness.

UNIT PLAN

3BHK 3T-TYPE 5

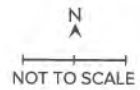

KEY PLAN



BLOCK - D & E

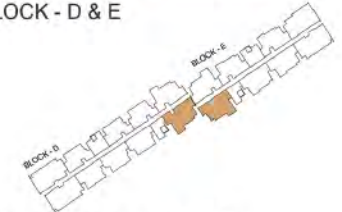

BLOCK - F & CLUBHOUSE



D-0030 - D-1830
 E-0042 - E-1842
 F-0049 - F-1749

SUPER BUILT-UP AREA

145.43 Sq.m
 1565 Sq.ft

CARPET AREA

99.62 Sq.m
 1072 Sq.ft

BALCONY AREA

4.24 Sq.m
 46 Sq.ft



The information depicted herein viz., master plans, floor plans, furniture layout, fittings, illustrations, specifications, designs, dimensions, rendered views, colours, amenities and facilities etc., are subject to change without notifications as may be required by the relevant authorities or the Developer's architect, and cannot form part of an offer or contract. Whilst every care is taken in providing this information, the Developer cannot be held liable for variations. All illustrations and pictures are artist's impressions only. The information is subject to variations, additions, deletions, substitutions and modifications as may be recommended by the company's architect and/or the relevant approving authorities. The Developer is wholly exempt from any liability on account of any claim in this regard. (1 square metre = 10.764 square feet). E & OE. All dimensions and calculations are done in metric system (M/Sq.m), and imperial system (Ft/Sq.ft) shown is for reference only. All dimensions indicated in the drawing are from unfinished surfaces, excluding plaster thickness and tile thickness.

UNIT PLAN

3BHK 3T 2 BALCONY - TYPE 3

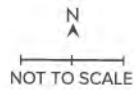

BLOCK - F & CLUBHOUSE



F-0052 - F-1752



| SUPER BUILT-UP AREA | CARPET AREA | BALCONY AREA |
|---------------------------|---------------------------|-----------------------|
| 155.55 Sq.m 1674 Sq.ft | 102.80 Sq.m 1107 Sq.ft | 7.97 Sq.m 86 Sq.ft |

The information depicted herein viz., master plans, floor plans, furniture layout, fittings, illustrations, specifications, designs, dimensions, rendered views, colours, amenities and facilities etc., are subject to change without notifications as may be required by the relevant authorities or the Developer's architect, and cannot form part of an offer or contract. Whilst every care is taken in providing this information, the Developer cannot be held liable for variations. All illustrations and pictures are artist's impressions only. The information is subject to variations, additions, deletions, substitutions and modifications as may be recommended by the company's architect and/or the relevant approving authorities. The Developer is wholly exempt from any liability on account of any claim in this regard. (1 square metre = 10.764 square feet). E & OE. All dimensions and calculations are done in metric system (M/Sq.m), and imperial system (Ft/Sq.ft) shown is for reference only. All dimensions indicated in the drawing are from unfinished surfaces, excluding plaster thickness and tile thickness.

UNIT PLAN

3BHK 3T STUDY - TYPE 1

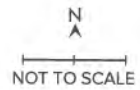

KEY PLAN



BLOCK - D & E

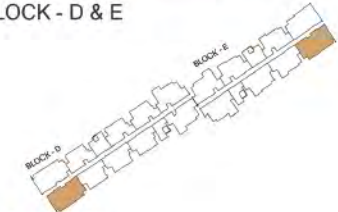

D-0034 - D-1834
E-0039 - E-1839

SUPER BUILT-UP AREA

166.25 Sq.m
1789 Sq.ft

CARPET AREA

110.68 Sq.m
1191 Sq.ft

BALCONY AREA

8.12 Sq.m
87 Sq.ft



The information depicted herein viz., master plans, floor plans, furniture layout, fittings, illustrations, specifications, designs, dimensions, rendered views, colours, amenities and facilities etc., are subject to change without notifications as may be required by the relevant authorities or the Developer's architect, and cannot form part of an offer or contract. Whilst every care is taken in providing this information, the Developer cannot be held liable for variations. All illustrations and pictures are artist's impressions only. The information is subject to variations, additions, deletions, substitutions and modifications as may be recommended by the company's architect and/or the relevant approving authorities. The Developer is wholly exempt from any liability on account of any claim in this regard. (1 square metre = 10.764 square feet). E & OE. All dimensions and calculations are done in metric system (M/Sq.m), and imperial system (Ft/Sq.ft) shown is for reference only. All dimensions indicated in the drawing are from unfinished surfaces, excluding plaster thickness and tile thickness.